

TIANG PJU H-13M DP TYPE SC
SCALE 1 : 100

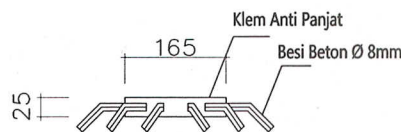

DET. 2. KLEM ANTI PANJAT
SCALE 1 : 25

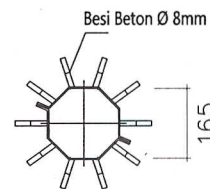
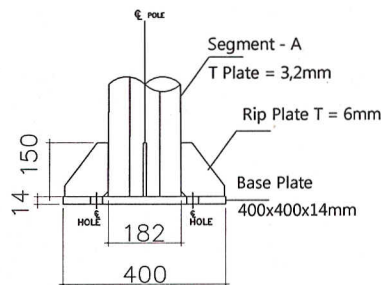

DET. 1. BASE PLATE
SCALE 1 : 25

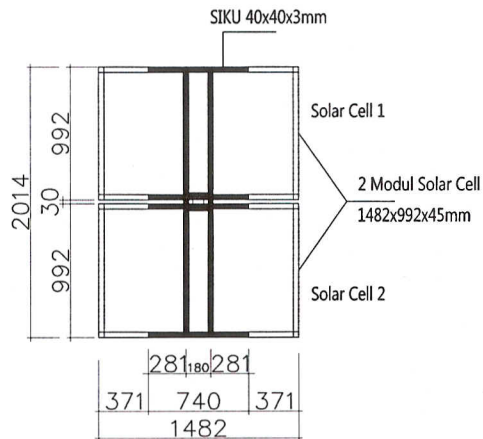

DET. 4. BRACKET MODUL SOLAR CELL
SCALE 1 : 25

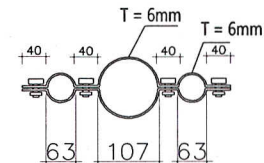

DET. 3. KLEM DOUBLE PARABOLE
SCALE 1 : 25

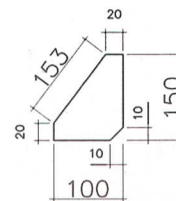

DET. 1. RIP PLATE
SCALE 1 : 25



DET. 3. KLEM DOUBLE PARABOLE
SCALE 1 : 25

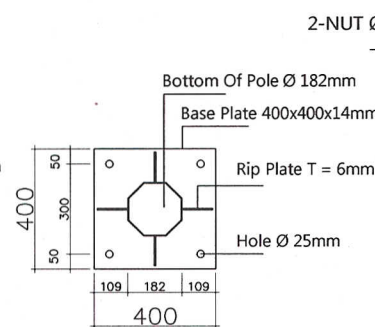

DET. 1. BASE PLATE
SCALE 1 : 25

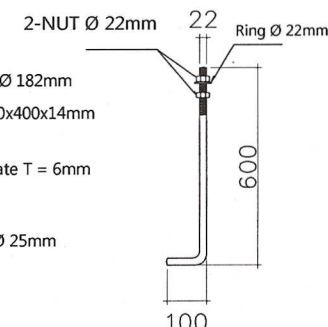

DET. 1. ANCHOR BOLT
SCALE 1 : 25

KETERANGAN

TECHNICAL SPECIFICATION :

- ISO 9001 : 2008
- Plate Baja : ST 41 / SS 400
- Welding : Las Listrik
- Finishing Hot Dip Galvanize
- Segment System Slip Joint
- Segment A = 6000mm
- Segment B = 4300mm
- Segment C = 3300mm
- Bottom Of Pole Ø 182mm
- Base Plate 400x400x14mm

PRODUCTION :



PT. HELORI GRAHASARANA

JOB TITLE :

TECHNICAL SPECIFICATION
POLE SOLAR CELL

CLIENT :

TOTAL :

DRAWING TITLE :

TIANG PJU OCTAGONAL
H-13M DOUBLE PARABOLE

DATE	CLIENT APPROVAL	APPROVAL



CAD	DESIGN	CHECK

Auto CAD 2009	Dwi. Y	Efi
---------------	--------	-----

DRAWING NO :	SHEET NO :
RL-DP-SC-H13M	SHEET 1 Of 1